

49th Annual Drosophila Research Conference Town & Country, April 2-6, 2008

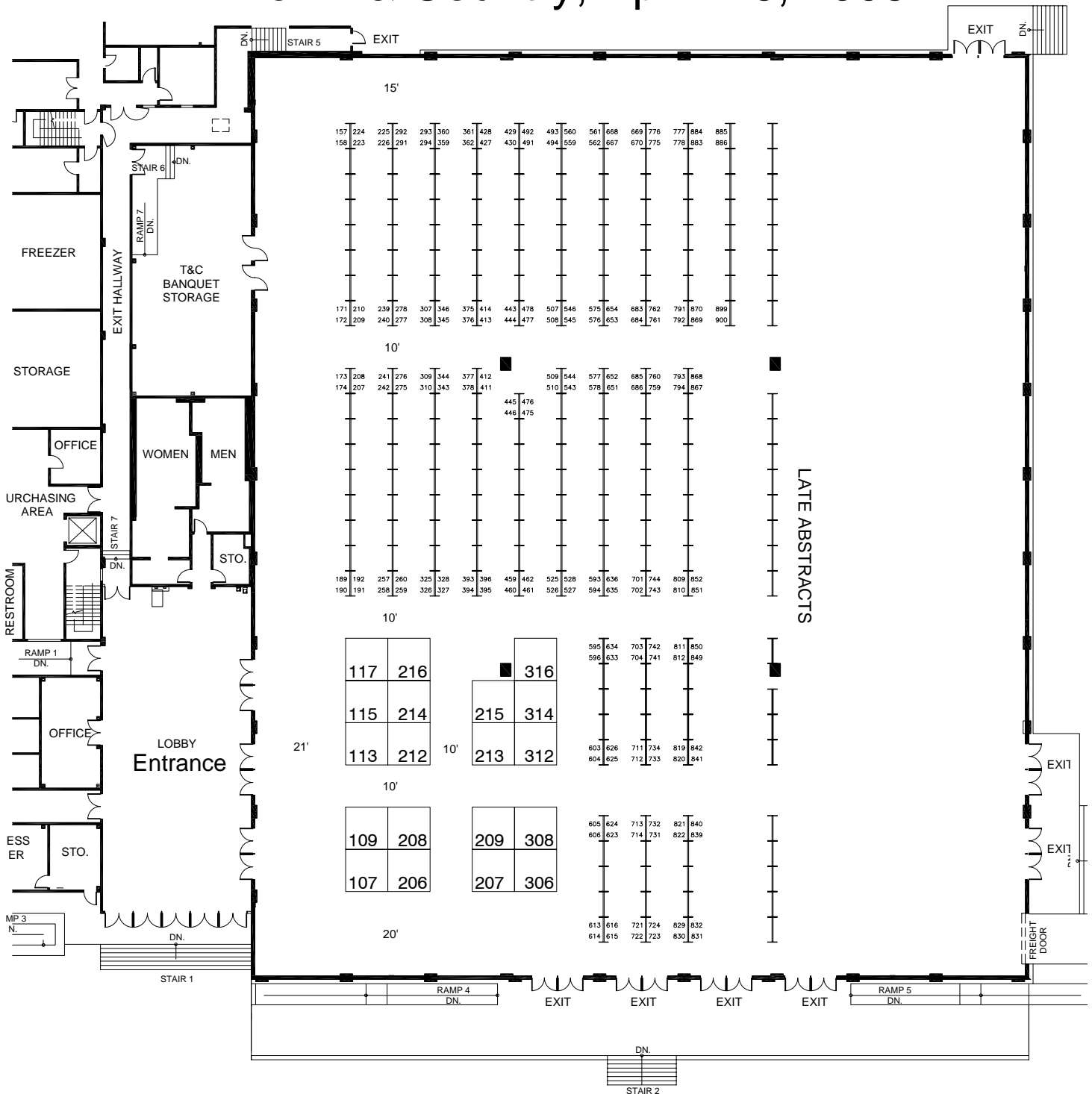

TOWN & COUNTRY RESORT & CONVENTION CENTER
GRAND EXHIBIT HALL
SAN DIEGO, CA

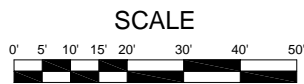

Inventory as of 01/21/2008

Dimension	Size	Qty	SqFt
10x10	100	19	1,900
Totals:		19	1,900

GES.

everything's possible

PLAN PREPARED BY:

5560 Katella Avenue
Cypress, CA 90630
PH: 562-370-1500 FX: 562-370-1699

SUBJECT TO FIRE MARSHALL APPROVAL

Copyright © by GES Exposition Services, All Rights Reserved. No part of this publication may be reproduced, stored in any retrieval system, or transmitted in any form by any means - electronic, mechanical photocopying, recording, or otherwise - without the express written consent of GES Exposition Services.

S-1267

25-03467

05-01-07

J.HAAS

08-27-07

M.SWENBERGER

08-28-07

08-29-07

01-21-08